

# KEENAN<sup>®</sup>

## VA Mixer Wagons

### Premium Vertical Auger Feeding Solutions



## “This is a story about two great Irish, globally-minded companies coming together”

Alltech® acquired KEENAN® in April of 2016.

Speaking at the announcement of the acquisition, the founder of Alltech, Dr. Pearse Lyons stated “Between Alltech’s primacy in science and KEENAN’s manufacturing strength and technological know-how, we have a winning combination for delivering greater farm efficiency and profitability direct to our farming customers”.

### About KEENAN

Established in 1978, KEENAN is a respected leader in ethical and profitable farming solutions, focused on maximising feed efficiency. Over the course of nearly four decades in business, we have earned a particularly strong reputation for manufacturing quality mixer wagons with cutting-edge designs.

At KEENAN we interpret data from almost 300,000 cows on 2,000 farms in 25 countries around the world, representing one of the world’s largest field databases on dairy feed efficiency.

A keen advocate for environmental sustainability, we have developed a range of solutions to enable farmers to overcome agricultural production challenges, improve rumen health and feed efficiency.



KEENAN Factory, Borris,  
Co. Carlow, Ireland.

### About Alltech

Founded in 1980 by Irish entrepreneur and scientist Dr. Pearse Lyons, Alltech improves the health and performance of people, animals and plants through nutrition and scientific innovation. With nearly 100 manufacturing sites globally, Alltech is a leading producer and processor of yeast and organic trace minerals.

The company’s guiding ACE principle seeks to develop solutions that are safe for the Animal, Consumer and the Environment and is actively supported by close to 5,000 team members worldwide.

Headquartered just outside of Lexington, Kentucky, USA, Alltech has a strong presence in all regions of the world.

For further information, visit [www.alltech.com](http://www.alltech.com)



Alltech Corporate  
Headquarters,  
Lexington, Kentucky.



### SPEED

Engineered to optimise use of space; the KEENAN VA2 and KEENAN VA3 range of machines allow materials to be rapidly and efficiently mixed into the overall total mixed ration (TMR).

### CAPACITY

The efficient use of space within the KEENAN VA2 and VA3 ranges means that machines may load and mix the full volumes of material consistent with their declared capacity.

### FOOTPRINT AND HANDLING

KEENAN VA2 and KEENAN VA3 mixers are extremely manoeuvrable machines; their footprint is designed to allow them fit into most modern farmyard buildings.

### HEAVY DUTY CHASSIS

The KEENAN VA machine is mounted on a custom-built heavy duty chassis (from 24m³ upwards). Its robust construction ensures durability and reliability even under the toughest conditions.

### SPRINT PADDLES

Sprint paddles help to speed up feed-out. A sprint paddle is fitted to each auger ensuring a constant rate of discharge of material.

### HEAVY DUTY AUGER AND BLADES

All KEENAN VA2 and VA3 machines are fitted with heavy duty augers as standard. The triangular blades are fitted with a long lasting tungsten coating increasing their longevity. Additionally, two blades are fitted towards the top of each auger for rapid incorporation of bales.

### TWO-SPEED GEARBOX

The two-speed gearbox means that when using low speed the power requirement from the tractor to start up a load is greatly reduced; while high speed can be used to ensure rapid, even emptying. Adjusting the two-speed gearbox could not be simpler - a mechanical cable control is fitted for moving between the low and high speeds.



# InTouch

INTOUCH IS A LIVE REVIEW AND SUPPORT SERVICE FEATURING ADVICE FROM SKILLED NUTRITIONISTS TO ENSURE ANIMALS MEET THEIR PERFORMANCE POTENTIAL EVERY DAY.

Working together with Intel®, our unique InTouch technology:

- Automates data sharing
- Enhances nutritional analysis
- Improves analytics
- Develops business models that provide solutions to farmers around the world

Live information and feedback is exchanged through the InTouchController, a website application and telephone support from a team of top nutritionists. Together meaning the InTouch service allows producers to have unrivalled control over the nutrition and performance of their herd.

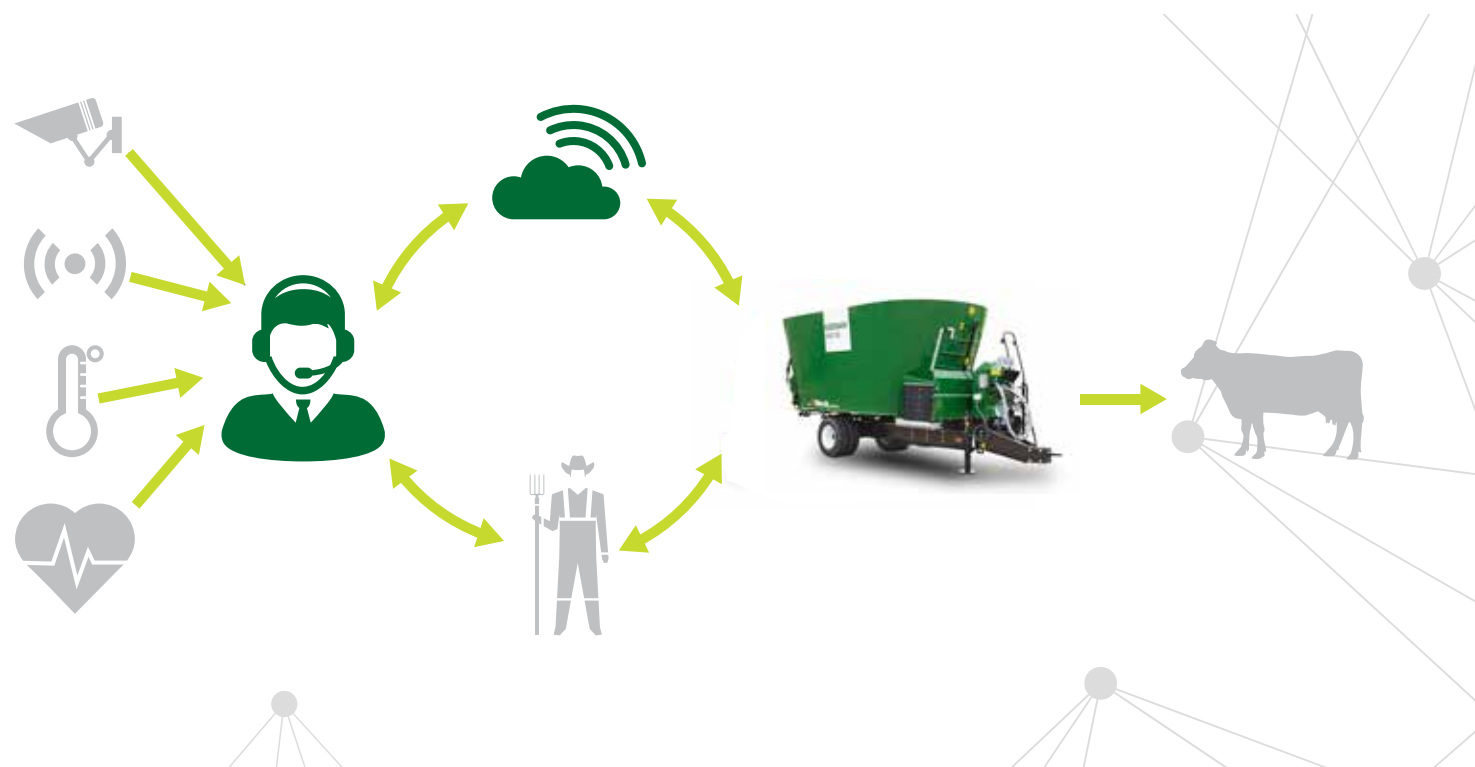

Cloud computing connecting 2,000+ customers globally.



Feeding 200,000+ animals.



30,000+ advice & nutrition support calls globally in 2015. Average wait time is less than 14 seconds.



Real-time automated cloud analytics monitored by nutritionists.



Global presence - Call centres in Ireland, France and New Zealand.



Providing the farmer with control, accuracy and real-time feed advice.



## InTouch Nutrition advice and mixing consistency



Diet formulation



Mixing sequence



Mixing time

**OPTIMISED MIX**

## How does InTouch Technology Work on Farm?

- Provides feed advice and ration formulation
- Delivers consistency in both feed and mixing
- Improves milk yields and milk solids
- Cattle meet finishing weight quicker
- Improves herd health
- Monitors and controls feed costs





The KEENAN VA range is designed to work every day under the toughest of conditions. Strength, reliability and the ability to handle all feeds are central features of the range. To ensure that machines are capable of dealing with a wide range of feeding situations, KEENAN includes a host of extras fitted as standard including:

- Heavy duty augers with long lasting tungsten coated blades
- Front right hand side (RHS) and rear left hand side (LHS) discharge doors with trays for dual feedout
- Two additional blades located at the top of each auger for faster processing of bales
- Inspection platform for viewing the mix
- Hydraulic brakes (Airbrakes standard from 30 cubic upwards)
- Sprint paddles to help ensure quick feed out
- Two-speed gearbox with mechanical cable adjustment to switch between gearbox speed
- Hay ring to prevent overflow of material



Counterknives to aid chopping and mixing (hydraulic optional)



Heavy duty chassis from 24m³ upwards

## THE KEENAN VA RANGE CAN ALSO BE FITTED WITH ADDITIONAL OPTIONS INCLUDING:

- Two side discharge doors both located at the front or at the rear of the machine
- Front mounted discharge conveyors
- Elevator extensions for front discharge conveyors (helping to achieve additional discharge height)
- Magnet kit to capture steel debris
- Viewing camera with screen in tractor cab for improved visibility
- Wide-angle PTO





# KEENAN®

## VA2-18

# KEENAN®

## VA2-21



The KEENAN VA2-18 is the smallest machine in the KEENAN VA range. With a lower footprint, the KEENAN VA2-18 affords greater mobility. The tank, augers and components of the KEENAN VA2-18 are manufactured using the same quality, strength and thickness of steel as the larger machines in the KEENAN VA range.

With a capacity of 21 cubic metres, the VA2 – 21 is made for the medium sized farmer who wants to feed a large amount of animals with one load. Sharing many of the components used in the larger range of KEENAN VA feeders, this model can be adapted to suit a wide range of farming applications.



# KEENAN® VA2-24S

# KEENAN® VA2-24L



The VA2-24S is the shorter option in the KEENAN VA 24m<sup>3</sup> range and is ideally suited for situations where space is limited and mobility is of prime importance. As with all machines of the KEENAN VA range, it comes with InTouch as standard to optimise the mix through implementing our unique algorithms for the exact mixing order, speed and number of rotations per load.

The KEENAN VA2-24L is the longer option in the KEENAN VA 24m<sup>3</sup> range of machines. The KEENAN VA2-24L is mounted on a heavy-duty chassis and features a robust gear box. This machine has a lower profile than the VA2-24S, giving the ability to be used on farms with height restrictions.



# KEENAN®

## VA2-30



The KEENAN VA2-30 is a heavy-duty machine with the capacity to feed large herds quickly. Multiple feed-out options to suit a variety of feeding situations are available with this machine. This applies to the full range of the KEENAN VA machines.

# KEENAN®

## VA2-33

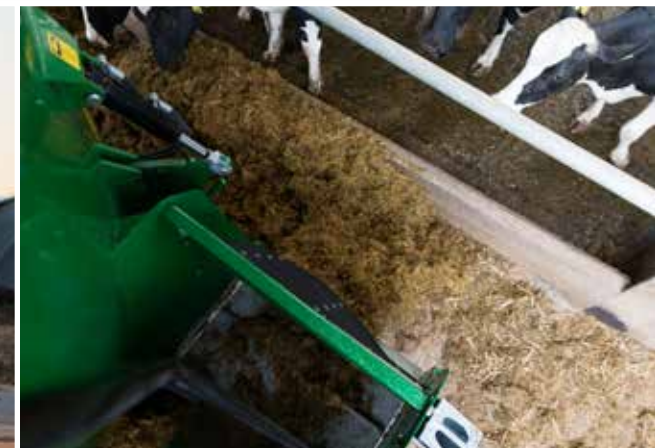

The KEENAN VA2-33 is the largest of the twin auger models and is designed to cope with the most demanding of applications on farm. Built to feed large numbers of animals, the control of on farm feeding operations with the InTouch feed management technology ensures mix quality is never compromised. Similar to other models in the range, feed out options can be adapted to suit individual farms.

# KEENAN® VA3

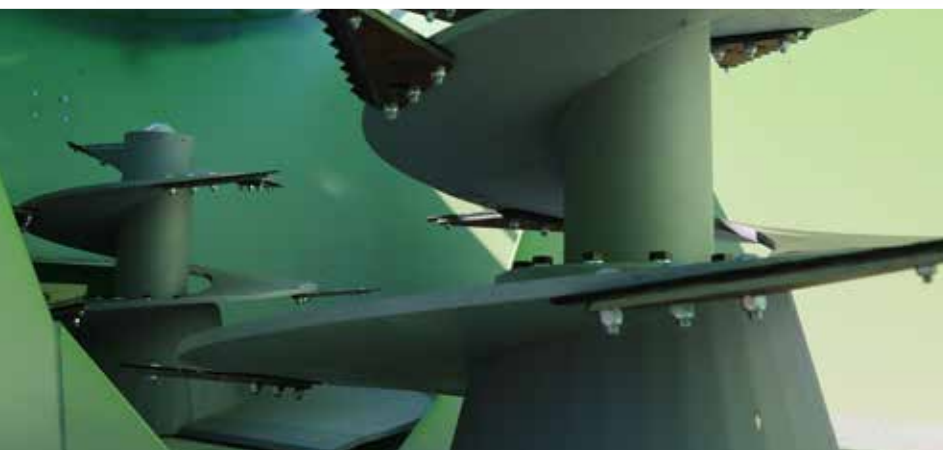

The KEENAN VA3 range has three different models, ranging in size from 36 -44 cubic metres to meet the feeding demands of the largest dairy and beef units globally.

Fitted with three augers, this range of vertical feeders are longer and narrower than their VA2 counterparts, and come with a range of feedout options. All machines in the KEENAN VA3 range are supplied as standard with the InTouch controller, guaranteeing an optimal TMR through precise loading and mixing times.

## MACHINE SPECIFICATIONS

**KEENAN VA2-18,  
KEENAN VA2-21,  
KEENAN VA2-24S**

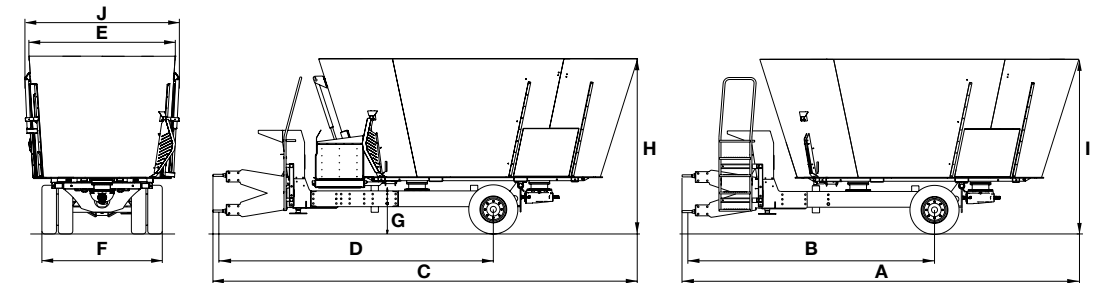

		A	B	C	D	E	F	G	H	I	J	Required Power**	Empty Weight**	Full Load Weight
	m³	mm	mm	mm	mm	mm	mm	mm	mm	mm	mm	kW-HP	kg	kg
KEENAN VA2-18	18	6,560	4,080	7,030	4,540	2,440	2,025	765	2,885	2,840	2,570	60 - 81	6,060	12,600
KEENAN VA2-21	21	6,720	4,080	7,360	4,720	2,450	2,180	875	3,080	3,080	2,590	66 - 90	7,100	16,000
KEENAN VA2-24S	24	6,780	4,080	7,420	4,720	2,480	2,180	875	3,320	3,320	2,590	70 - 95	7,720	16,000

**KEENAN VA2-24L, KEENAN VA2-27, KEENAN VA2-30, KEENAN VA2-33**

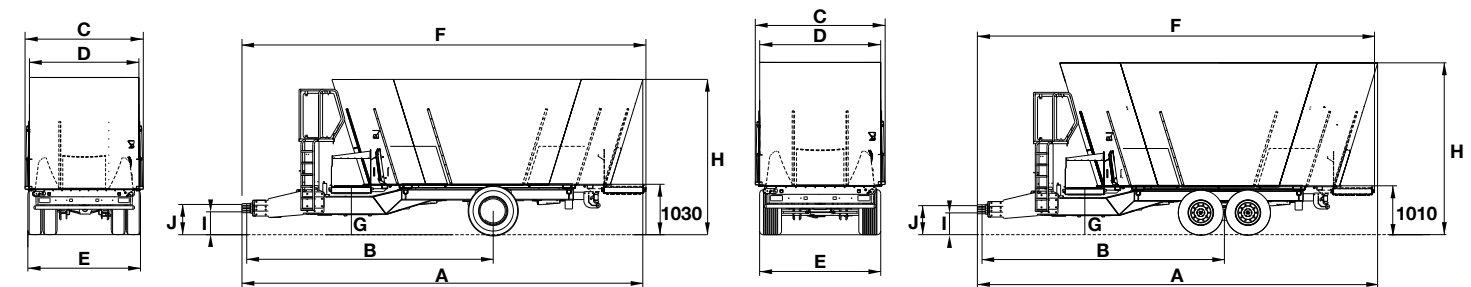

		A	B	C	D	E	F	G	H	I	J	Required Power*	Empty Weight**	Full Load Weight
	m³	mm	mm	mm	mm	mm	mm	mm	mm	mm	mm	kW-HP	kg	kg
KEENAN VA2-24L	24	8,145	5,030	2,700	2,500	2,510	8,210	960	2,970	465	610	82 - 110	9,950	17,500
KEENAN VA2-27	27	8,145	5,030	2,700	2,500	2,510	8,210	960	3,155	465	610	82 - 110	10,150	17,500
KEENAN VA2-30	30	8,200	5,030	2,700	2,500	2,510	8,210	950	3,340	450	600	104 - 140	10,750	22,500
KEENAN VA2-33	33	8,270	5,030	2,700	2,500	2,510	8,210	950	3,565	450	600	104 - 140	11,000	22,500

**KEENAN VA3-36,  
KEENAN VA3-40,  
KEENAN VA3-44**

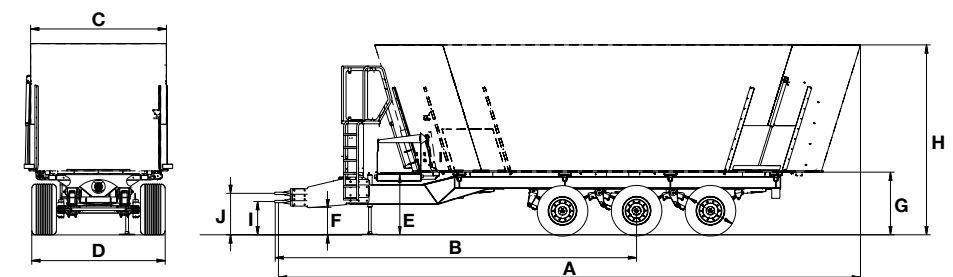

		A	B	C	D	E	F	G	H	I	J	Required Power*	Empty Weight**	Full Load Weight
	m³	mm	mm	mm	mm	mm	mm	mm	mm	mm	mm	kW-HP	kg	kg
KEENAN VA3-36	36	10,580	6,650	2,500	2,510	1,110	500	1,150	3,100	610	760	156 - 210	16,200	32,500
KEENAN VA3-40	40	10,650	6,650	2,500	2,510	1,110	500	1,150	3,310	610	760	156 - 210	16,450	32,500
KEENAN VA3-44	44	10,700	6,650	2,500	2,510	1,110	500	1,150	3,490	610	760	156 - 210	16,700	32,500

\*Power requirement dependent on loaded products.

\*\*Approximate weight. Actual weight subject to options fitted to the machine.



Alltech Farming Solutions Ltd,  
Alltech House,  
Ryhall Road, Stamford  
Lincs, PE9 1TZ

**Tel: 01780 437 519**

**Email: [keenaninfo@alltech.com](mailto:keenaninfo@alltech.com)**



[keenansystem.com](http://keenansystem.com)

 [KEENANGlobal](#)

 [@KEENANsystem](#)